

TecsPak® Bumpers

Typical applications include:

GBA

- Sawmill and Debarking Equipment
- Mining/Heavy Construction Machinery
- Gantry/Trolley, Shipyard Bulkhead and Heavy Door Bumpers
- Steel Mill Press Room, Stamping and Foundry Equipment

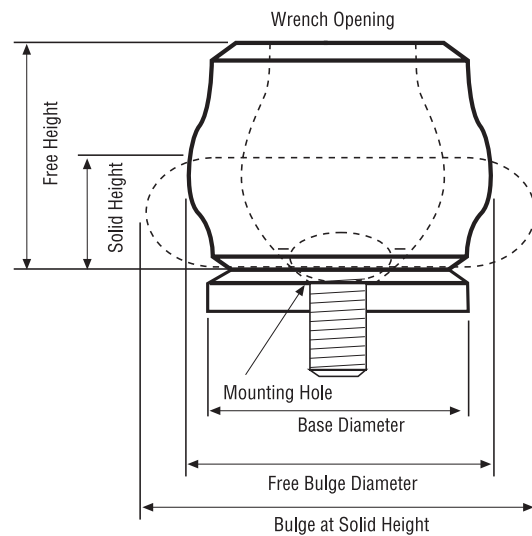

| BUMPER | FREE HEIGHT | FREE BULGE | WRENCH OPENING | BASE DIA. | MOUNTING HOLE | SOLID HEIGHT | BULGE @ SOLID HT. | RATED ENERGY CAPACITY (IN-LBS.) | PEAK DYNAMIC FORCE (LBS.) | SHIPPING WEIGHT (OZ.) |
|--------|-------------|------------|----------------|-----------|---------------|--------------|-------------------|---------------------------------|---------------------------|-----------------------|
| GBA-1 | 0.76 | 0.85 | 0.41 | 0.75 | 0.31 | 0.40 | 1.07 | 100 | 700.00 | 0.16 |
| GBA-2 | 1.01 | 1.11 | 0.56 | 0.98 | 0.31 | 0.53 | 1.43 | 250 | 1,200 | 0.37 |
| GBA-3 | 1.18 | 1.35 | 0.66 | 1.16 | 0.31 | 0.63 | 1.70 | 400 | 2,000 | 0.62 |
| GBA-4 | 1.31 | 1.47 | 0.72 | 1.28 | 0.31 | 0.69 | 1.88 | 550 | 2,400 | 0.86 |
| GBA-5 | 1.37 | 1.55 | 0.80 | 1.35 | 0.42 | 0.73 | 1.97 | 700 | 2,500 | 1.00 |
| GBA-6 | 1.49 | 1.70 | 0.79 | 1.48 | 0.42 | 0.80 | 2.15 | 900 | 3,600 | 1.40 |
| GBA-7 | 1.62 | 1.83 | 0.93 | 1.61 | 0.55 | 0.86 | 2.33 | 1100 | 3,300 | 1.70 |
| GBA-8 | 1.77 | 1.96 | 1.02 | 1.71 | 0.55 | 0.92 | 2.51 | 1400 | 3,800 | 2.00 |
| GBA-9 | 1.86 | 2.14 | 1.04 | 1.85 | 0.55 | 0.99 | 2.69 | 1700 | 5,000 | 2.20 |
| GBA-10 | 2.02 | 2.25 | 1.16 | 1.97 | 0.55 | 1.06 | 2.86 | 2000 | 5,000 | 3.10 |
| GBA-11 | 2.11 | 2.43 | 1.23 | 2.08 | 0.55 | 1.12 | 3.05 | 2500 | 5,300 | 3.70 |
| GBA-12 | 2.26 | 2.54 | 1.30 | 2.23 | 0.55 | 1.19 | 3.22 | 3000 | 6,100 | 4.60 |
| GBA-13 | 2.38 | 2.70 | 1.38 | 2.35 | 0.55 | 1.25 | 3.40 | 3500 | 6,600 | 5.10 |
| GBA-14 | 2.54 | 2.81 | 1.41 | 2.46 | 0.81 | 1.32 | 3.58 | 4000 | 7,500 | 6.10 |
| GBA-15 | 2.72 | 3.10 | 1.57 | 2.71 | 0.79 | 1.45 | 3.94 | 5000 | 8,300 | 7.80 |
| GBA-16 | 2.91 | 3.22 | 1.69 | 2.82 | 0.81 | 1.52 | 4.12 | 6000 | 8,700 | 9.10 |
| GBA-17 | 3.00 | 3.35 | 1.70 | 2.95 | 0.81 | 1.58 | 4.30 | 7000 | 9,600 | 10.60 |
| GBA-18 | 3.13 | 3.50 | 1.78 | 3.07 | 0.81 | 1.65 | 4.48 | 8000 | 10,800 | 11.80 |
| GBA-19 | 3.37 | 3.83 | 1.92 | 3.34 | 0.81 | 1.78 | 4.83 | 10000 | 14,000 | 14.90 |
| GBA-20 | 3.98 | 4.56 | 2.26 | 3.39 | 0.81 | 2.11 | 5.73 | 17000 | 18,500 | 26.10 |