

# SWING CLAMPS W/ CAM HANDLE - MINIATURE

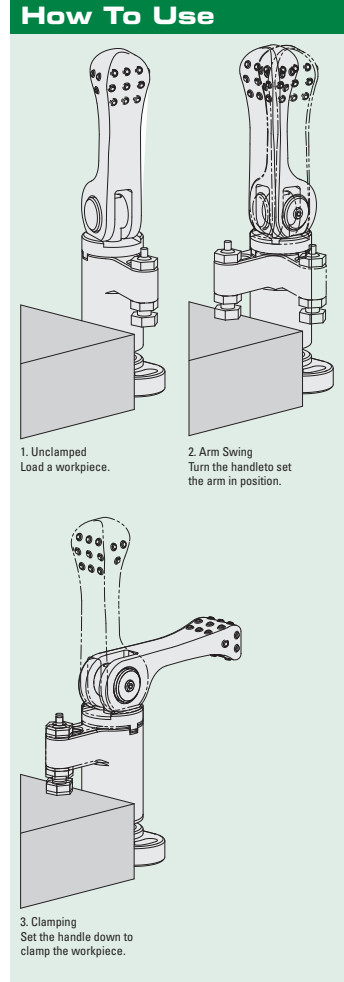
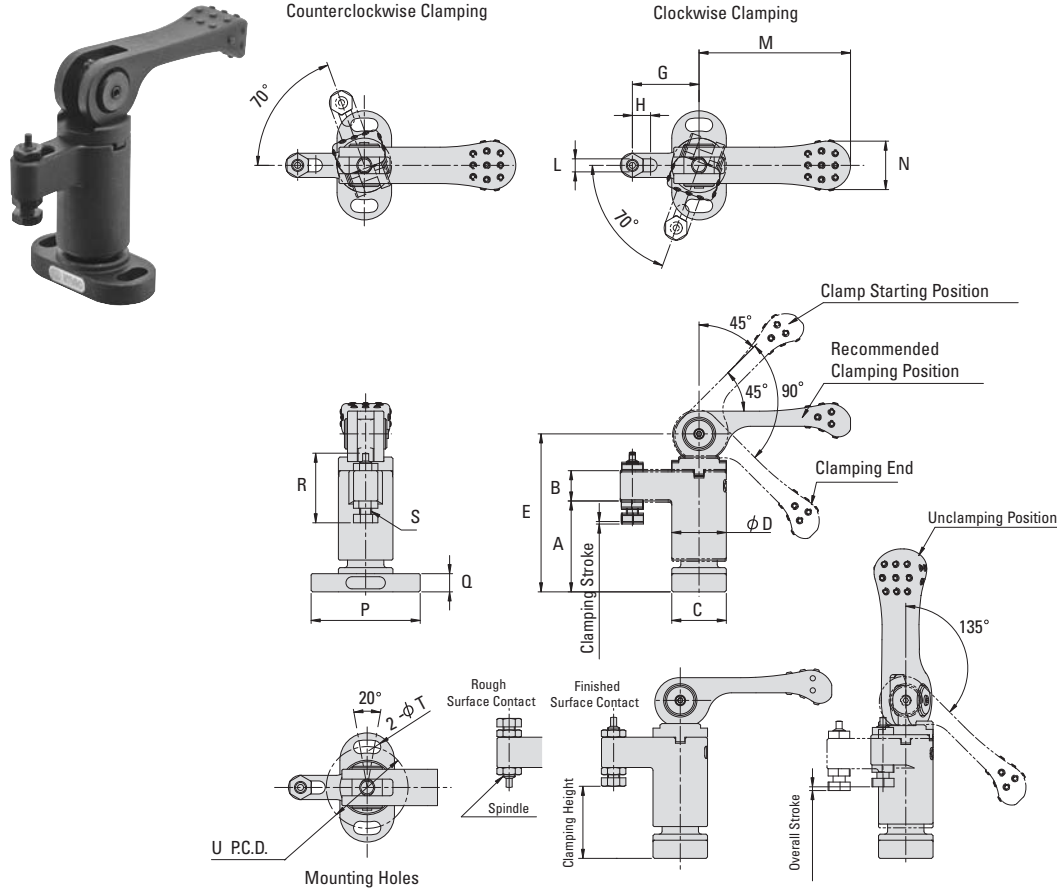

These miniature cam action clamps swing into position and clamp straight down onto the work piece for direct downward pressure. The arm swings completely out of the way to allow for easy loading and unloading of the work piece. Ideal for repetitive clamping operations. Comes with a contact bolt that can be reversed for finished or rough surfaces. Mounts from the top with two mounting holes. The 100 series provide 179 lbs of clamping force, the 150 series provides 337 lbs of clamping force. Part numbers ending with R have a clockwise clamping direction, part numbers ending in L have a counter clockwise clamping direction. Maximum load to operate the handle is 22 lbs. for the 100 series and 33 lbs. for the 150 series. The body, washer and spindle are made from SAE-1045 alloy steel. The clamp arm, shaft and handle are made from SAE-4140 alloy steel. Parts are heat treated with black oxide finish.

Part #	Clamping Height		Clamping Stroke	Overall Stroke
	Finished Surface	Rough Surface		
QLSWC100VR	22.4 - 25.2	22.0 - 24.8	0.8	1.2
QLSWC100VL	22.4 - 25.2	22.0 - 24.8	0.8	1.2
QLSWC150VR	30.8 - 33.8	31.7 - 34.7	1.0	1.5
QLSWC150VL	30.8 - 33.8	31.7 - 34.7	1.0	1.5

Part #	A	B	C	D	E	G	H	L	M	N	P	Q	R	S	T	U
	mm	mm	mm	mm	mm	mm	mm	mm	mm	mm	mm	mm	mm	mm	mm	mm
QLSWC100VR	30	10	18	18	52	22	6	4.3	50	15	36	6	22.8	M4X0.7	4.3	27
QLSWC100VL	30	10	18	18	52	22	6	4.3	50	15	36	6	22.8	M4X0.7	4.3	27
QLSWC150VR	40	14	23	23	68	30	8	5.3	63	20	45	8	28.5	M5X0.8	5.3	34
QLSWC150VL	40	14	23	23	68	30	8	5.3	63	20	45	8	28.5	M5X0.8	5.3	34

\*Pitch Circle Diameter