

## ADJUSTABLE CLAMP HANDLES

### Stainless Steel | Female Threads | Inch and Metric

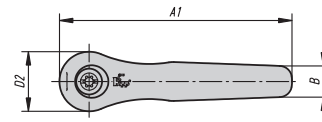
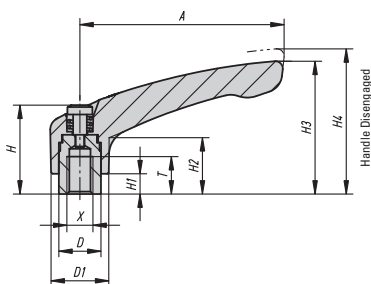

Pulling up on the handle disengages it from the spline and allows it to rotate freely for adjustment. Releasing the handle engages it for tightening or adjusting. The handles and all internal components are made from stainless steel. Designed for medical, food and marine applications.

#### INCH

Part #	X Thread	T	D	D1	D2	H	H1	H2	H3	H4	A	A1	B	No. Of Teeth
06454-1A0	10-24	.35	.39	.51	.55	.96	.16	.57	1.22	1.34	1.57	1.85	.28	16
06454-1A1	10-32	.35	.39	.51	.55	.96	.16	.57	1.22	1.34	1.57	1.85	.28	16
06454-1A2	1/4-20	.35	.39	.51	.55	.96	.16	.57	1.22	1.34	1.57	1.85	.28	16
06454-2A2	1/4-20	.47	.53	.73	.75	1.12	.26	.69	1.67	1.79	2.56	2.93	.39	20
06454-2A3	5/16-18	.47	.53	.73	.75	1.12	.26	.69	1.67	1.79	2.56	2.93	.39	20
06454-3A3	5/16-18	.55	.63	.83	.87	1.46	.39	.94	2.15	2.30	3.15	3.58	.43	22
06454-3A4	3/8-16	.55	.63	.83	.87	1.46	.39	.94	2.15	2.30	3.15	3.58	.43	22
06454-4A4	3/8-16	.67	.75	1.06	1.08	1.69	.39	1.06	2.48	2.66	3.74	4.29	.51	24
06454-4A5	1/2-13	.67	.75	1.06	1.08	1.69	.39	1.06	2.48	2.66	3.74	4.29	.51	24

#### METRIC

Part #	X Thread	T mm	D mm	D1 mm	D2 mm	H mm	H1 mm	H2 mm	H3 mm	H4 mm	A mm	A1 mm	B mm	No. Of Teeth
06454-105	M5	9	10	13	14	24.5	4	14.5	31	34	40	47	7	16
06454-106	M6	9	10	13	14	24.5	4	14.5	31	34	40	47	7	16
06454-206	M6	12	13.5	18.5	19	28.5	6.5	17.5	42.5	45.5	65	74.5	10	20
06454-208	M8	12	13.5	18.5	19	28.5	6.5	17.5	42.5	45.5	65	74.5	10	20
06454-308	M8	14	16	21	22	37	10	24	54.5	58.5	80	91	11	22
06454-310	M10	14	16	21	22	37	10	24	54.5	58.5	80	91	11	22
06454-410	M10	17	19	27	27.5	43	10	27	63	67.5	95	109	13	24
06454-412	M12	17	19	27	27.5	43	10	27	63	67.5	95	109	13	24

# ADJUSTABLE CLAMP HANDLES

## Stainless Steel | Male Threads | Inch

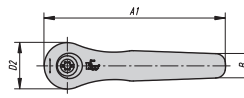
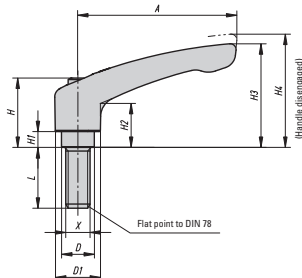

Pulling up on the handle disengages it from the spline and allows it to rotate freely for adjustment. Releasing the handle engages it for tightening or adjusting. The handles, studs and all internal components are made from stainless steel. Designed for medical, food and marine applications.

### INCH

Part #	X Thread	L	D	D1	D2	H	H1	H2	H3	H4	A	A1	B	No. Of Teeth
06464-1A0X10	10-24	.39	.39	.51	.55	.96	.16	.57	1.22	1.34	1.57	1.85	.28	16
06464-1A0X15	10-24	.59	.39	.51	.55	.96	.16	.57	1.22	1.34	1.57	1.85	.28	16
06464-1A0X20	10-24	.79	.39	.51	.55	.96	.16	.57	1.22	1.34	1.57	1.85	.28	16
06464-1A0X25	10-24	.98	.39	.51	.55	.96	.16	.57	1.22	1.34	1.57	1.85	.28	16
06464-1A1X15	10-32	.59	.39	.51	.55	.96	.16	.57	1.22	1.34	1.57	1.85	.28	16
06464-1A1X20	10-32	.79	.39	.51	.55	.96	.16	.57	1.22	1.34	1.57	1.85	.28	16
06464-1A1X25	10-32	.98	.39	.51	.55	.96	.16	.57	1.22	1.34	1.57	1.85	.28	16
06464-1A2X10	1/4-20	.39	.39	.51	.55	.96	.16	.57	1.22	1.34	1.57	1.85	.28	16
06464-1A2X15	1/4-20	.59	.39	.51	.55	.96	.16	.57	1.22	1.34	1.57	1.85	.28	16
06464-1A2X20	1/4-20	.79	.39	.51	.55	.96	.16	.57	1.22	1.34	1.57	1.85	.28	16
06464-1A2X25	1/4-20	.98	.39	.51	.55	.96	.16	.57	1.22	1.34	1.57	1.85	.28	16
06464-1A2X30	1/4-20	1.18	.39	.51	.55	.96	.16	.57	1.22	1.34	1.57	1.85	.28	16
06464-1A2X40	1/4-20	1.57	.39	.51	.55	.96	.16	.57	1.22	1.34	1.57	1.85	.28	16
06464-1A2X50	1/4-20	1.97	.39	.51	.55	.96	.16	.57	1.22	1.34	1.57	1.85	.28	16
06464-2A2X15	1/4-20	.59	.53	.73	.75	1.12	.26	.69	1.67	1.79	2.56	2.93	.39	24
06464-2A2X20	1/4-20	.79	.53	.73	.75	1.12	.26	.69	1.67	1.79	2.56	2.93	.39	24
06464-2A2X25	1/4-20	.98	.53	.73	.75	1.12	.26	.69	1.67	1.79	2.56	2.93	.39	24
06464-2A2X30	1/4-20	1.18	.53	.73	.75	1.12	.26	.69	1.67	1.79	2.56	2.93	.39	24
06464-2A2X40	1/4-20	1.57	.53	.73	.75	1.12	.26	.69	1.67	1.79	2.56	2.93	.39	24
06464-2A2X50	1/4-20	1.97	.53	.73	.75	1.12	.26	.69	1.67	1.79	2.56	2.93	.39	24
06464-2A2X60	1/4-20	2.36	.53	.73	.75	1.12	.26	.69	1.67	1.79	2.56	2.93	.39	24
06464-2A3X15	5/16-18	.59	.53	.73	.75	1.12	.26	.69	1.67	1.79	2.56	2.93	.39	24
06464-2A3X20	5/16-18	.79	.53	.73	.75	1.12	.26	.69	1.67	1.79	2.56	2.93	.39	24
06464-2A3X25	5/16-18	.98	.53	.73	.75	1.12	.26	.69	1.67	1.79	2.56	2.93	.39	24
06464-2A3X30	5/16-18	1.18	.53	.73	.75	1.12	.26	.69	1.67	1.79	2.56	2.93	.39	24
06464-2A3X40	5/16-18	1.57	.53	.73	.75	1.12	.26	.69	1.67	1.79	2.56	2.93	.39	24
06464-2A3X50	5/16-18	1.97	.53	.73	.75	1.12	.26	.69	1.67	1.79	2.56	2.93	.39	24
06464-2A3X60	5/16-18	2.36	.53	.73	.75	1.12	.26	.69	1.67	1.79	2.56	2.93	.39	24
06464-2A4X20	3/8-16	.79	.53	.73	.75	1.12	.26	.69	1.67	1.79	2.56	2.93	.39	24
06464-2A4X25	3/8-16	.98	.53	.73	.75	1.12	.26	.69	1.67	1.79	2.56	2.93	.39	24
06464-2A4X30	3/8-16	1.18	.53	.73	.75	1.12	.26	.69	1.67	1.79	2.56	2.93	.39	24
06464-2A4X40	3/8-16	1.57	.53	.73	.75	1.12	.26	.69	1.67	1.79	2.56	2.93	.39	24
06464-2A4X50	3/8-16	1.97	.53	.73	.75	1.12	.26	.69	1.67	1.79	2.56	2.93	.39	24
06464-2A4X60	3/8-16	2.36	.53	.73	.75	1.12	.26	.69	1.67	1.79	2.56	2.93	.39	24
06464-3A3X20	5/16-18	.79	.63	.83	.87	1.46	.39	.94	2.15	2.30	3.15	3.58	.43	22
06464-3A3X25	5/16-18	.98	.63	.83	.87	1.46	.39	.94	2.15	2.30	3.15	3.58	.43	22
06464-3A3X30	5/16-18	1.18	.63	.83	.87	1.46	.39	.94	2.15	2.30	3.15	3.58	.43	22
06464-3A3X40	5/16-18	1.57	.63	.83	.87	1.46	.39	.94	2.15	2.30	3.15	3.58	.43	22
06464-3A3X50	5/16-18	1.97	.63	.83	.87	1.46	.39	.94	2.15	2.30	3.15	3.58	.43	22
06464-3A3X60	5/16-18	2.36	.63	.83	.87	1.46	.39	.94	2.15	2.30	3.15	3.58	.43	22
06464-3A4X20	3/8-16	.79	.63	.83	.87	1.46	.39	.94	2.15	2.30	3.15	3.58	.43	22
06464-3A4X25	3/8-16	.98	.63	.83	.87	1.46	.39	.94	2.15	2.30	3.15	3.58	.43	22
06464-3A4X30	3/8-16	1.18	.63	.83	.87	1.46	.39	.94	2.15	2.30	3.15	3.58	.43	22
06464-3A4X40	3/8-16	1.57	.63	.83	.87	1.46	.39	.94	2.15	2.30	3.15	3.58	.43	22
06464-3A4X50	3/8-16	1.97	.63	.83	.87	1.46	.39	.94	2.15	2.30	3.15	3.58	.43	22
06464-3A4X60	3/8-16	2.36	.63	.83	.87	1.46	.39	.94	2.15	2.30	3.15	3.58	.43	22
06464-4A5X25	1/2-13	.98	.75	1.06	1.08	1.69	.39	1.06	2.48	2.66	3.74	4.29	.51	24
06464-4A5X30	1/2-13	1.18	.75	1.06	1.08	1.69	.39	1.06	2.48	2.66	3.74	4.29	.51	24
06464-4A5X40	1/2-13	1.57	.75	1.06	1.08	1.69	.39	1.06	2.48	2.66	3.74	4.29	.51	24
06464-4A5X50	1/2-13	1.97	.75	1.06	1.08	1.69	.39	1.06	2.48	2.66	3.74	4.29	.51	24
06464-4A5X60	1/2-13	2.36	.75	1.06	1.08	1.69	.39	1.06	2.48	2.66	3.74	4.29	.51	24

## ADJUSTABLE CLAMP HANDLES

### Stainless Steel | Male Threads | Metric

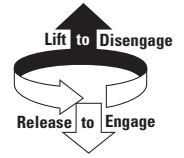
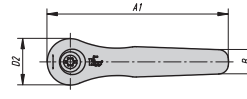
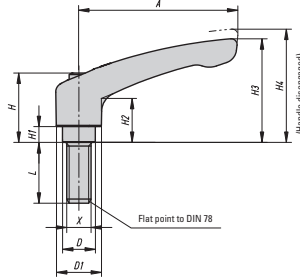

Pulling up on the handle disengages it from the spline and allows it to rotate freely for adjustment. Releasing the handle engages it for tightening or adjusting. The handles, studs and all internal components are made from stainless steel. Designed for medical, food and marine applications.

#### METRIC

Part #	X Thread	L mm	D mm	D1 mm	D2 mm	H mm	H1 mm	H2 mm	H3 mm	H4 mm	A mm	A1 mm	B mm	No. Of Teeth
06464-105X10	M5	10	10	13	14	24.5	4	14.5	31	34	40	47	7	16
06464-105X15	M5	15	10	13	14	24.5	4	14.5	31	34	40	47	7	16
06464-105X20	M5	20	10	13	14	24.5	4	14.5	31	34	40	47	7	16
06464-105X25	M5	25	10	13	14	24.5	4	14.5	31	34	40	47	7	16
06464-106X10	M6	10	10	13	14	24.5	4	14.5	31	34	40	47	7	16
06464-106X15	M6	15	10	13	14	24.5	4	14.5	31	34	40	47	7	16
06464-106X20	M6	20	10	13	14	24.5	4	14.5	31	34	40	47	7	16
06464-106X25	M6	25	10	13	14	24.5	4	14.5	31	34	40	47	7	16
06464-106X30	M6	30	10	13	14	24.5	4	14.5	31	34	40	47	7	16
06464-106X40	M6	40	10	13	14	24.5	4	14.5	31	34	40	47	7	16
06464-106X50	M6	50	10	13	14	24.5	4	14.5	31	34	40	47	7	16
06464-206X15	M6	15	13.5	18.5	19	28.5	6.5	17.5	42.5	45.5	65	74.5	10	20
06464-206X20	M6	20	13.5	18.5	19	28.5	6.5	17.5	42.5	45.5	65	74.5	10	20
06464-206X25	M6	25	13.5	18.5	19	28.5	6.5	17.5	42.5	45.5	65	74.5	10	20
06464-206X30	M6	30	13.5	18.5	19	28.5	6.5	17.5	42.5	45.5	65	74.5	10	20
06464-206X40	M6	40	13.5	18.5	19	28.5	6.5	17.5	42.5	45.5	65	74.5	10	20
06464-206X50	M6	50	13.5	18.5	19	28.5	6.5	17.5	42.5	45.5	65	74.5	10	20
06464-206X60	M6	60	13.5	18.5	19	28.5	6.5	17.5	42.5	45.5	65	74.5	10	20
06464-208X15	M8	15	13.5	18.5	19	28.5	6.5	17.5	42.5	45.5	65	74.5	10	20
06464-208X20	M8	20	13.5	18.5	19	28.5	6.5	17.5	42.5	45.5	65	74.5	10	20
06464-208X25	M8	25	13.5	18.5	19	28.5	6.5	17.5	42.5	45.5	65	74.5	10	20
06464-208X30	M8	30	13.5	18.5	19	28.5	6.5	17.5	42.5	45.5	65	74.5	10	20
06464-208X40	M8	40	13.5	18.5	19	28.5	6.5	17.5	42.5	45.5	65	74.5	10	20
06464-208X50	M8	50	13.5	18.5	19	28.5	6.5	17.5	42.5	45.5	65	74.5	10	20
06464-208X60	M8	60	13.5	18.5	19	28.5	6.5	17.5	42.5	45.5	65	74.5	10	20
06464-210X20	M10	20	13.5	18.5	19	28.5	6.5	17.5	42.5	45.5	65	74.5	10	20
06464-210X25	M10	25	13.5	18.5	19	28.5	6.5	17.5	42.5	45.5	65	74.5	10	20
06464-210X30	M10	30	13.5	18.5	19	28.5	6.5	17.5	42.5	45.5	65	74.5	10	20
06464-210X40	M10	40	13.5	18.5	19	28.5	6.5	17.5	42.5	45.5	65	74.5	10	20
06464-210X50	M10	50	13.5	18.5	19	28.5	6.5	17.5	42.5	45.5	65	74.5	10	20
06464-210X60	M10	60	13.5	18.5	19	28.5	6.5	17.5	42.5	45.5	65	74.5	10	20
06464-308X20	M8	20	16	21	22	37	10	24	54.5	58.5	80	91	11	22
06464-308X25	M8	25	16	21	22	37	10	24	54.5	58.5	80	91	11	22
06464-308X30	M8	30	16	21	22	37	10	24	54.5	58.5	80	91	11	22
06464-308X40	M8	40	16	21	22	37	10	24	54.5	58.5	80	91	11	22
06464-308X50	M8	50	16	21	22	37	10	24	54.5	58.5	80	91	11	22
06464-308X60	M8	60	16	21	22	37	10	24	54.5	58.5	80	91	11	22
06464-310X20	M10	20	16	21	22	37	10	24	54.5	58.5	80	91	11	22
06464-310X25	M10	25	16	21	22	37	10	24	54.5	58.5	80	91	11	22
06464-310X30	M10	30	16	21	22	37	10	24	54.5	58.5	80	91	11	22
06464-310X40	M10	40	16	21	22	37	10	24	54.5	58.5	80	91	11	22
06464-310X50	M10	50	16	21	22	37	10	24	54.5	58.5	80	91	11	22
06464-310X60	M10	60	16	21	22	37	10	24	54.5	58.5	80	91	11	22
06464-412X25	M12	25	19	27	28	43	10	27	63	67.5	95	109	13	24
06464-412X30	M12	30	19	27	28	43	10	27	63	67.5	95	109	13	24
06464-412X40	M12	40	19	27	28	43	10	27	63	67.5	95	109	13	24
06464-412X50	M12	50	19	27	28	43	10	27	63	67.5	95	109	13	24
06464-412X60	M12	60	19	27	28	43	10	27	63	67.5	95	109	13	24